

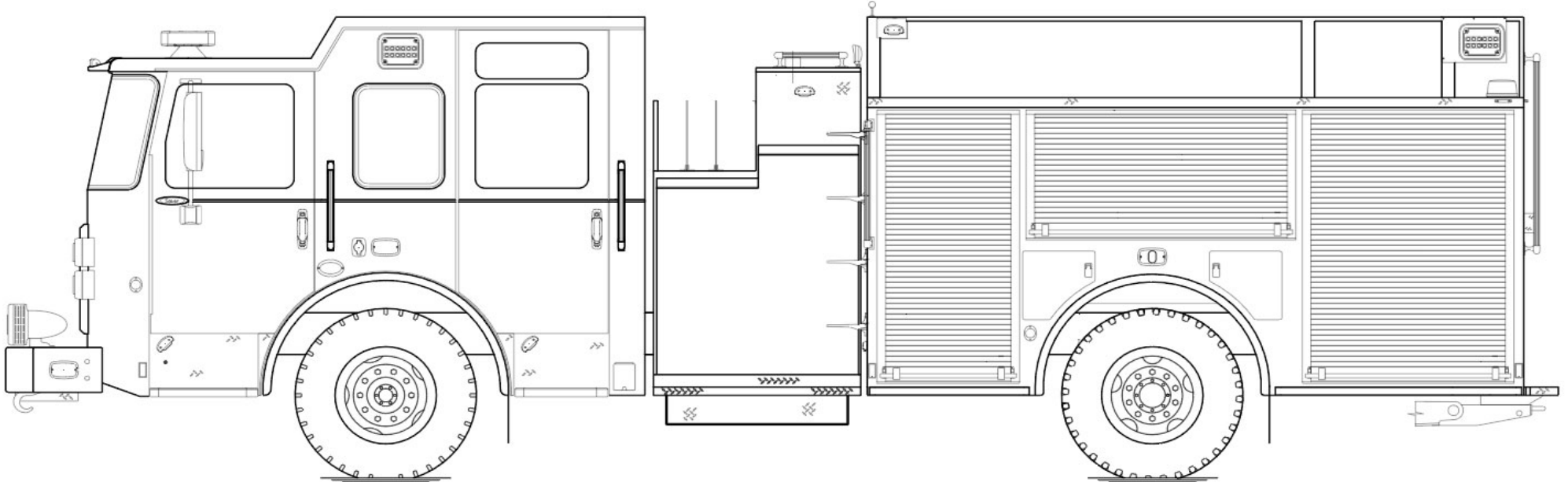

PERFORM. LIKE NO OTHER.™

# Vernon Fire Department, WI

## Saber® Pumper



### CHASSIS

<b>Chassis</b>	60" <b>Saber</b> cab w/ 10" raised roof
<b>Seating Capacity</b>	6
<b>Overall Height</b>	9' 8"
<b>Overall Length</b>	29' 11.5"
<b>GVW Rating</b>	44,000 lb
<b>Front Axle</b>	Dana D-2000F, 20,000 lb
<b>Rear Axle</b>	Dana S23-190, 24,000 lb
<b>Engine</b>	<b>PACCAR MX-13</b> , 510 hp, 1850 lb-ft

### BODY

<b>Material</b>	Aluminum
<b>Compartmentation</b>	152" full height
<b>Doors</b>	Rollup
<b>Pump Tank</b>	Waterous, 1,500 gpm 750 gallons w/ low hosebed, approximately 64" from the ground
<b>Pump Panel</b>	<b>Pierce® Control Zone™</b> , 48" w/ three crosslays
<b>Foam</b>	Provisions for future foam system
<b>Foam Cell</b>	20 gallons

