

HOSEBED CAPACITIES
 ① 1000' OF 5.00" KEY PRO-FLOW HOSE
 ② 600' OF 3.00" KEY PRO-FLOW HOSE

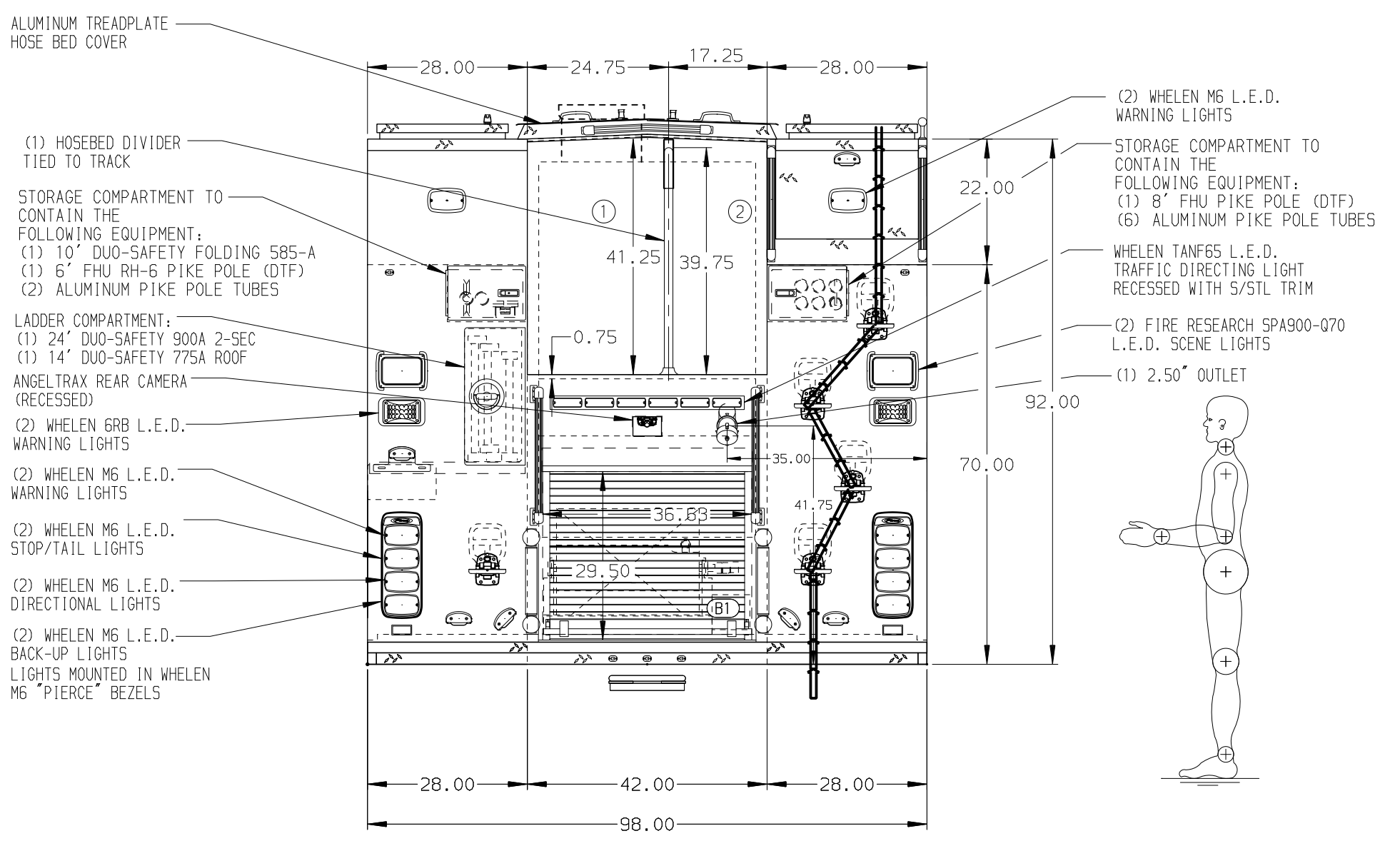
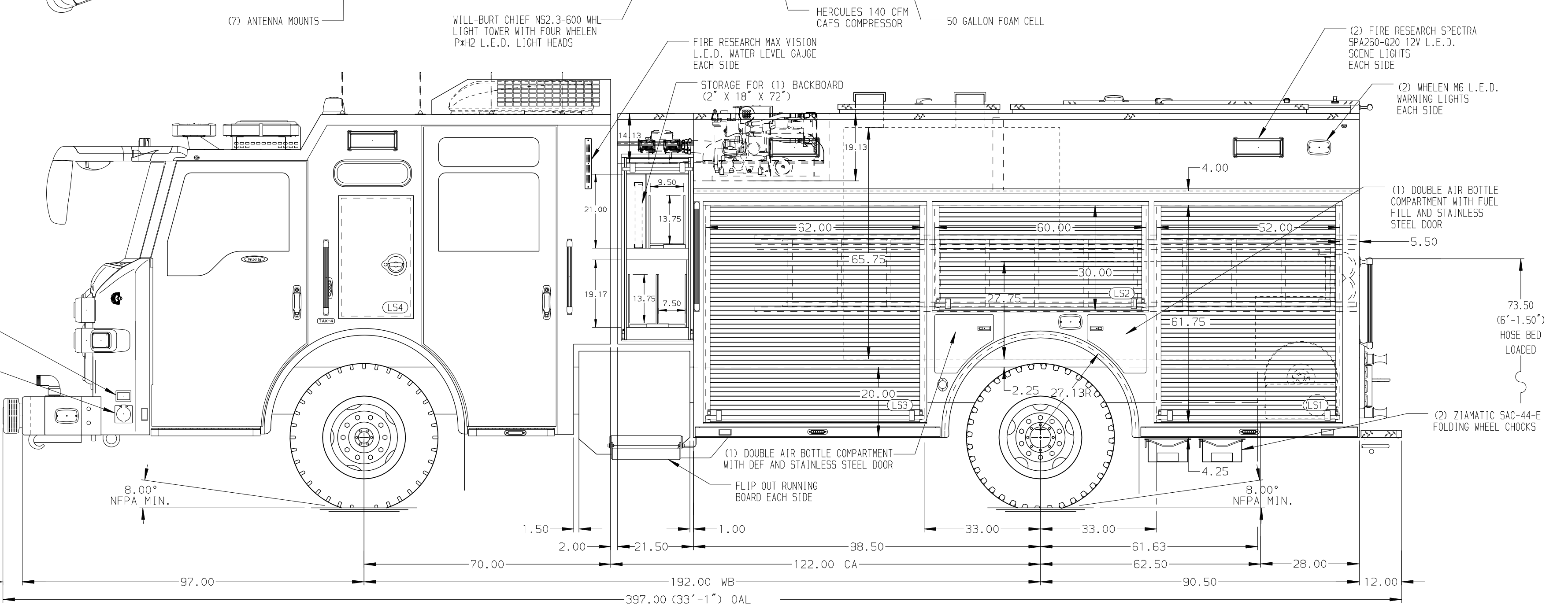

ALUMINUM BODY

SIDE ROLL AND FRONTAL IMPACT PROTECTION

NOTE
 DIMENSIONS SHOWN ARE APPROXIMATE AND ARE SUBJECT TO MINOR DEVIATIONS AS MAY OCCUR OR BE NECESSARY IN CONSTRUCTION. MINOR DETAILS NOT SHOWN.

- 1. BATTERY CHARGER LOCATED BEHIND DRIVER SEAT
- 2. AIR INLET/OUTLET LOCATED ON DS PUMP PANEL
- 3. SUB FEED BREAKER BOX LOCATED BEHIND THE DRIVER SEAT

REV	DATE	BY	CH	VELOCITY FR
07JUL23	LME	PHA		CHASSIS DATA
22JUN23	LME	PHA		MAKE
05APR23	LME	PHA		PIERCE
				MODEL

		JOB NO.	37935
		SCALE	DATE
TITLE	1500-D-800P, 750 WATER W/ 50 FOAM, 189" PUC RESCUE	DRAWN BY	LME
FOR	CITY OF COLLEGE STATION FIRE DEPARTMENT	CHECKED BY	MGE
DWG NO.	37935AD-SH1	SHEET SIZE	SHEET NO.
		D	1 OF 2