

PUMPER BODY
Medium Aluminum 2nd Gen Pumper

CHASSIS
Enforcer Chassis

CHASSIS AXLE, FRONT, CUSTOM
19,500 lb TAK-4 Axle

AXLE, REAR
24,000 lb Meritor Axle

ENGINE
450 HP Cummins L9 Engine

TRANSMISSION
Allison 6th Gen, 3000 EVS P

BUMPER
10" Extended Painted Steel

CAB
6010 Enforcer Cab

BODY TOTAL TANK CAPACITY
500 Gallon Milwaukee Style Poly Tank

WATER CAPACITY
500 Gallons of Water

FOAM CELL
Foam Cell Not Required

COMPT, PUMPER, REAR
21.00" FF Lap Rear Compt

COMPT, PUMPER, LEFT SIDE
152" Lap Full Height Front & Rear FDLER

COMPT, PUMPER, RIGHT SIDE
152" Lap Full Height & Depth Front & Rear BIB

FIRE SUPPRESSION PUMPHOUSE
45" Control Zone Side Mount

PUMP
2000 GPM Waterous CSU

DEADLAYS, 1.75"
(1) 1.75" Standard Capacity

CROSSLAYS
CrossLays Not Required

SPEEDLAYS
SpeedLays Not Required

GENERATOR
Generator Not Required

FOAM SYSTEM
Foam System Not Required

SAFETY
Side Roll and Frontal Impact Protection

NOTE
DIMENSIONS SHOWN ARE APPROXIMATE AND ARE SUBJECT TO MINOR DEVIATIONS AS MAY OCCUR OR BE NECESSARY IN CONSTRUCTION. MINOR DETAILS NOT SHOWN.

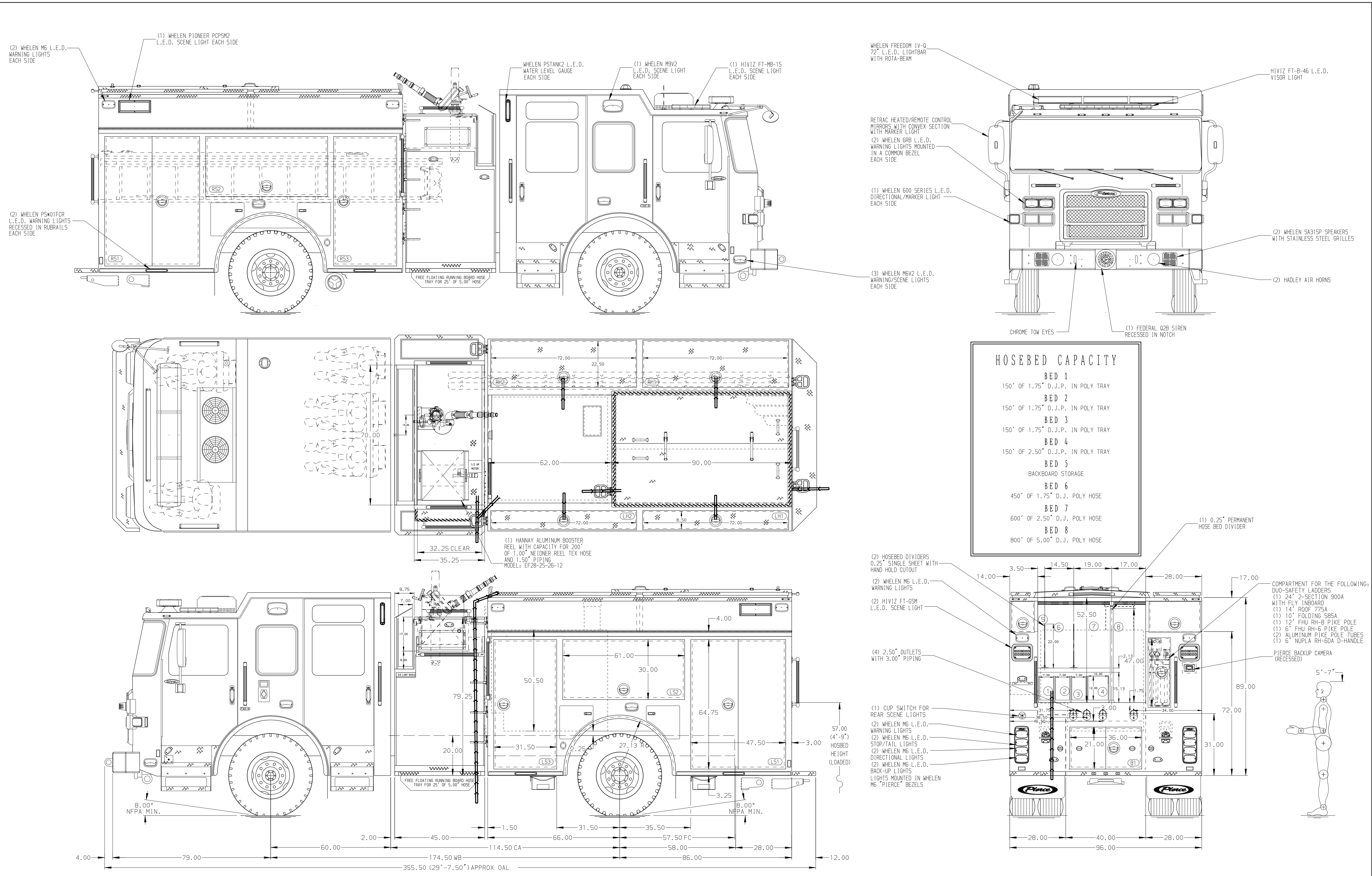

- SHORELINE RECEPTACLE WITH KUSSMAUL SUPER AUTO-EJECT LOCATED ON DRIVER SIDE OF THE CAB
- AIR INLET WITH DISCONNECT COUPLING IN THE DRIVER SIDE STEPPWELL
- BATTERY CHARGER LOCATED PER ORDER
- BATTERY CHARGE INDICATOR LOCATED BEHIND DS DOOR
- TEN ADJUSTABLE SHELVES LOCATED PER ORDER
- EIGHT PARTITIONS LOCATED PER ORDER
- PEGBOARD ON BACK WALL IN COMPARTMENT PER SHOP ORDER
- PEGBOARD ON SIDE WALL IN COMPARTMENT PER SHOP ORDER
- AUTOMATIC TIRE CHAINS

REV	DATE	BY	CH	ENFORCER
1	12FEB25	JAM	GKH	CHASSIS DATA
2	28JAN25	JAM	GKH	MAKE
3	03SEP24	JAM	GKH	PIERCE
4	18JUN24	MMF	GKH	MODEL

Pierce MANUFACTURING INC.		JOB NO.	40332-01-02
TITLE		SCALE	DATE
Pierce Pumper Approval Drawing		1:24	
FOR		DRAWN BY	JAM
Redmond, City Of		CHECKED BY	MMF
DWG NO.		SHEET SIZE	SHEET NO.
40332AD		D	1 OF 1