

PUMPER BODY
 Long Aluminum 2nd Gen Pumper
CHASSIS
 EnForcer Chassis
ELECTRICAL SYSTEM
 Hard Wired

CHASSIS AXLE, FRONT, CUSTOM
 19,500 Lb TAK-4 Axle
AXLE, REAR
 27,000 Lb Meritor Axle
ENGINE
 455 HP Cummins X12 Engine
TRANSMISSION
 Allison 6th Gen, 4000 EVS P
BUMPER
 26" Underslung Extended Painted Steel
CAB
 7010 EnForcer Cab

BODY TOTAL TANK CAPACITY
 1030 Gallon Poly Tank
WATER CAPACITY
 1000 Gallons of Water
FOAM CELL CAPACITY
 30 Gallon Foam Cell
COMPT, PUMPER, REAR
 37.75" FF RollUp Rear Compt
COMPT, PUMPER, LEFT SIDE
 161" RollUp Full Height & Depth Front & Rear
COMPT, PUMPER, RIGHT SIDE
 161" RollUp Full Height Front & Rear FDLER

FIRE SUPPRESSION PUMPHOUSE
 42" Control Zone Side Mount
PUMP
 1500 GPM Hale QMAX-X5
CROSSLAYS, 1.50"
 1.50" Crosslays Not Required
CROSSLAYS, 2.50"
 (1) 2.50" Standard Capacity
SPEEDLAYS
 (2) 1.50" Standard Capacity With Poly Trays
GENERATOR
 Generator Not Required
FOAM SYSTEM
 Akron Educator Foam System

SAFETY
 Not Required

NOTE
 DIMENSIONS SHOWN ARE APPROXIMATE AND ARE SUBJECT TO MINOR DEVIATIONS AS MAY OCCUR OR BE NECESSARY IN CONSTRUCTION. MINOR DETAILS NOT SHOWN.

- AIR INLET/OUTLET WITH DISCONNECT FITTING LOCATED PER ORDER
- BATTERY CHARGER LOCATED PER ORDER
- BATTERY CHARGER INDICATOR LOCATED PER ORDER
- SEVEN FULL WIDTH/DEPTH ADJUSTABLE SHELVES WITH SIDES LOCATED PER ORDER
- ONE FLOOR MOUNTED SLIDE-OUT TRAY WITH SIDES LOCATED PER ORDER
- ONE CTECH FOUR DRAWER CABINET LOCATED PER ORDER
- TWO SLIDE-OUT TOOLBOARDS LOCATED PER ORDER
- ONE VERTICAL PARTITION LOCATED PER ORDER
- FIRE EXTINGUISHER STORAGE BIN FOR TEN FIRE EXTINGUISHERS LOCATED PER ORDER
- ONE 120V DUPLEX RECEPTACLE IN REAR BODY LOCATED PER ORDER

11. INVERTER LOCATED PER ORDER

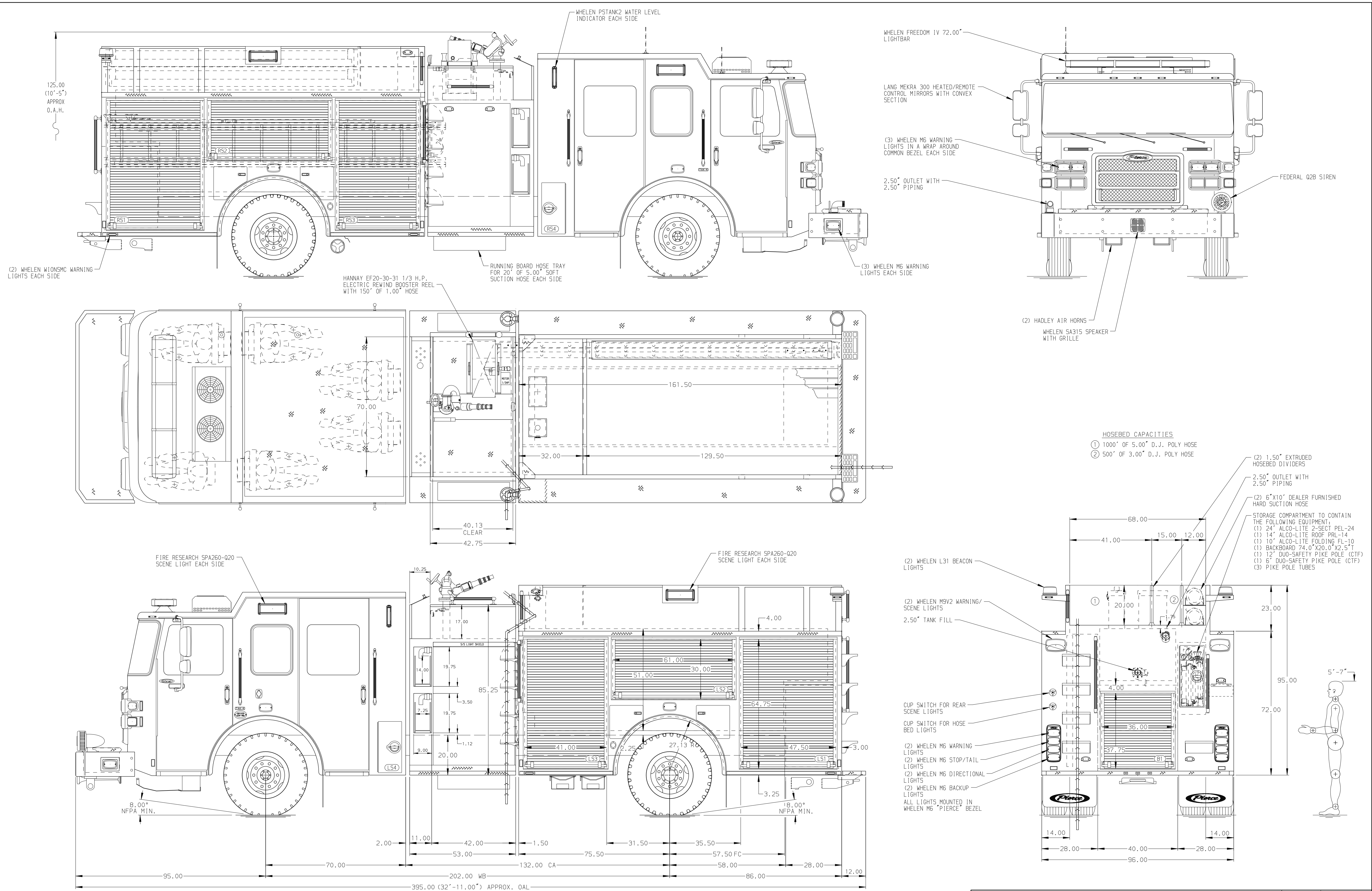

		JOB NO.	41329
		SCALE	DATE
TITLE	Pierce Pumper Approval Drawing	DRAWN BY	BST
FOR	North Fort Myers Fire Control & Rescue Service Dist	CHECKED BY	AMI
DWG NO.	41329AD	SHEET SIZE	SHEET NO.
		D	1 OF 1

REV	DATE	BY	CH	ENFORCER
09FEB26	BST	ZWE	MAKE	
02SEP25	BST	ZWE	PIERCE	
08AUG25	BST	ZWE	MODEL	