

- Ground Ladder Storage**
- (2) 35' Alco-Lite 2-Section PEL
  - (2) 28' Alco-Lite 2-Section PEL
  - (1) 24' Alco-Lite 2-Section PEL
  - (1) 20' Alco-Lite Roof PRL
  - (3) 16' Alco-Lite Roof PRL
  - (2) 16' Alco-Lite Roof DRL
  - (1) 14' Alco-Lite Roof PRL
  - (1) 14' Duo-Safety Attic/Fresno 701
  - (4) Pike Pole Tubes
  - (1) D-Handle Trough

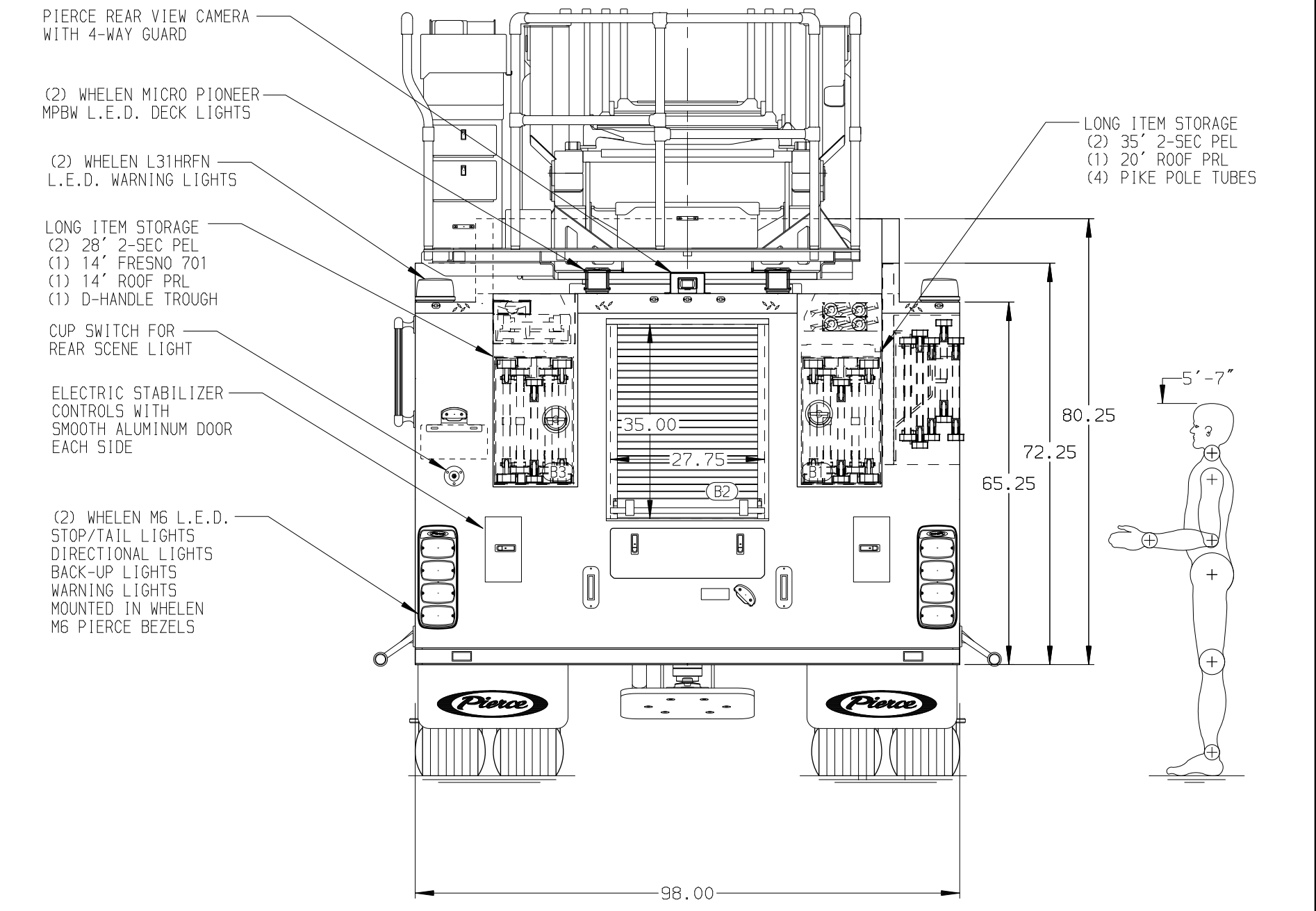
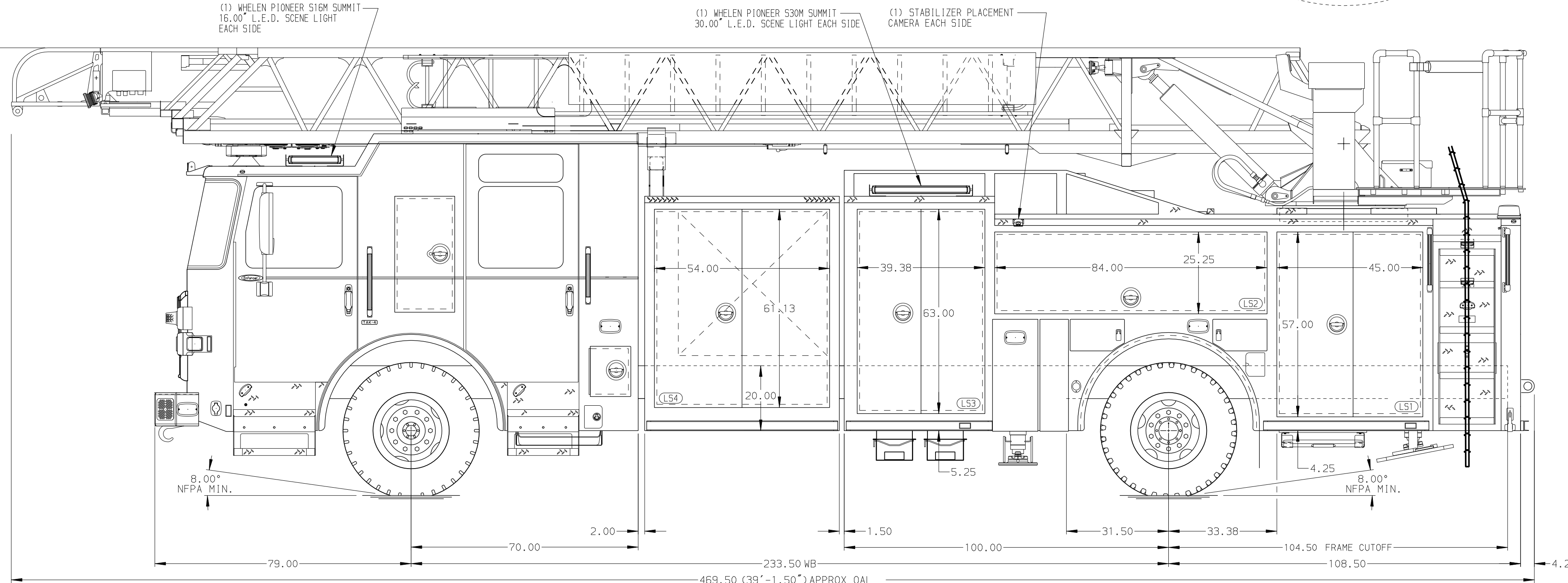

<b>CHASSIS</b> Enforcer Chassis <b>ENGINE</b> 510 HP Paccar MX Engine	<b>CAB</b> 7010 Enforcer Cab <b>BUMPER</b> 10" Extended Painted Steel	<b>AXLE, FRONT, CUSTOM</b> 22,800 Lb TAK-4 Axle <b>AXLE, REAR</b> 33,500 Lb Meritor Axle	<b>TRANSMISSION</b> Allison 6th Gen, 4000 EVS P <b>GENERATOR</b> Generator Not Required	<b>COMPARTMENT-NO PUMP</b> 60" Wide w/Double Doors	<b>SAFETY</b> Side Roll and Frontal Impact Protection
--	--	---	--	---	---

**CUSTOMER APPROVAL**  
APPROVED BY: \_\_\_\_\_  
DATE: \_\_\_\_\_

**Pierce MANUFACTURING INC.**

JOB NO. 44763  
SCALE 1:24  
DATE \_\_\_\_\_

**NOTE**  
DIMENSIONS SHOWN ARE APPROXIMATE AND ARE SUBJECT TO MINOR DEVIATIONS AS MAY OCCUR OR BE NECESSARY IN CONSTRUCTION. MINOR DETAILS NOT SHOWN.

1. NO LIMITED RETRACTION REQUIRED
  2. AKRON 1495 LADDER PIPE WITH 497 MOUNTING BRACKET MOUNTED AT PICKUP
  3. SHORELINE RECEPTACLE WITH KUSSMALL SUPER AUTO-EJECT LOCATED ON DRIVER SIDE OF THE CAB
  4. AIR INLET WITH DISCONNECT COUPLING LOCATED IN THE DRIVER SIDE STEPWELL
  5. BATTERY CHARGER LOCATED BEHIND DRIVER SEAT
  6. BATTERY CHARGE INDICATOR LOCATED ON THE DRIVER'S SEAT RISER
  7. FIVE ADJUSTABLE SHELVES LOCATED IN COMPARTMENTS PER ORDER
  8. FOUR FLOOR MOUNTED SLIDE-OUT TRAYS LOCATED IN COMPARTMENTS PER ORDER
  9. NON-RAISED AERIAL PEDESTAL
  10. LIFTING EYE ROPE RESCUE ATTACHMENT AT AERIAL TIP
11. DC POWER TO AERIAL TIP

REV	DATE	BY	CH	ENFORCER
020C12S	LWE	AST		
06JUN25	LWE	JLO		

**107 ASCENDANT AERIAL LADDER & BODY ASSEMBLY NO PUMP/NO TANK**

FOR PIERCE FIELD UNIT  
APPLETON, WI

DWG NO. **44763AD**

CHECKED BY JLO  
DATE 28MAY25  
SHEET SIZE D  
SHEET NO. 1 OF 1