

- HOSEBED CAPACITIES**
- ① - 600' OF 2.50" D.J. POLY HOSE
 - ② - 1000' OF 5.00" D.J. POLY HOSE

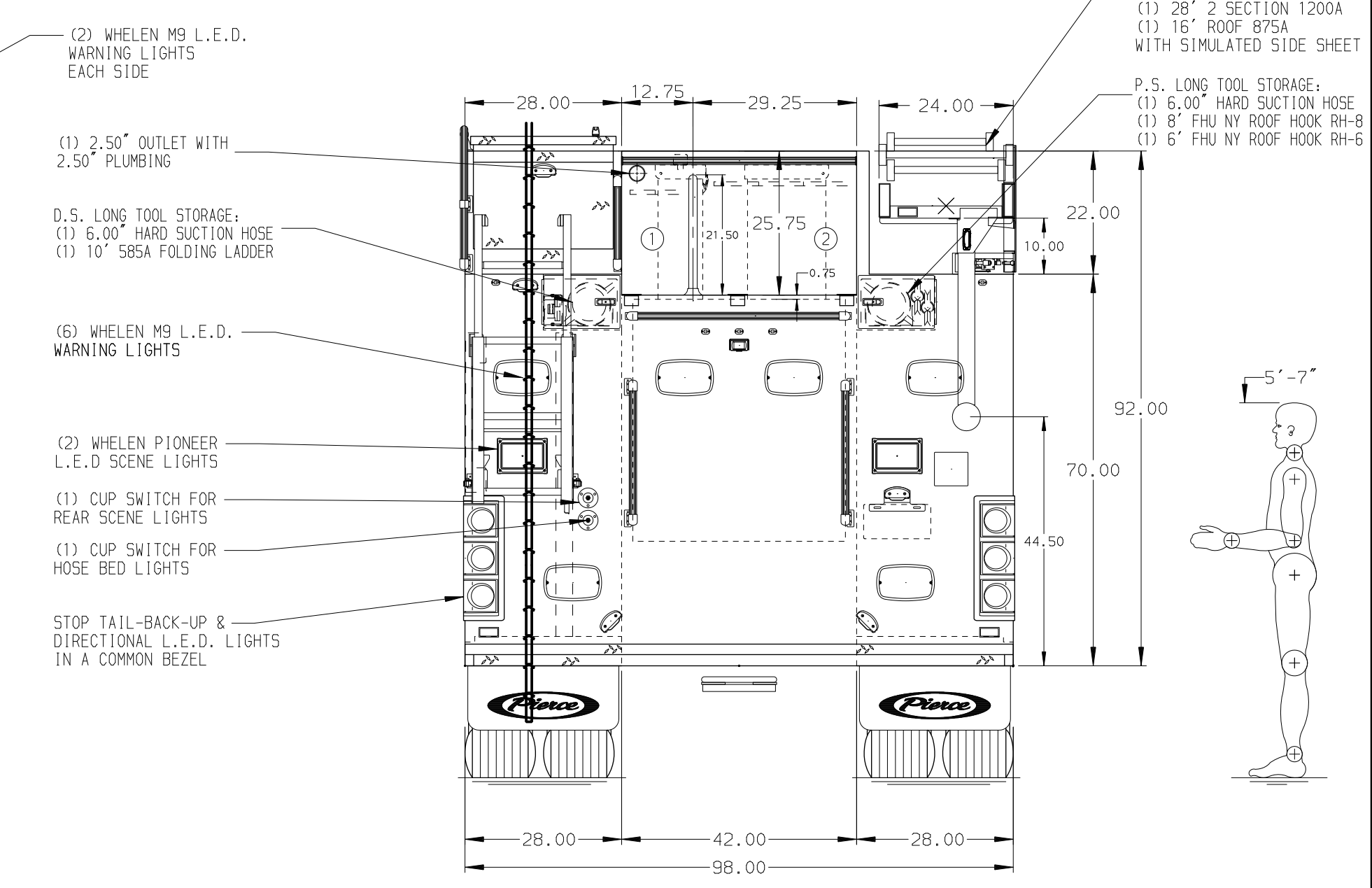
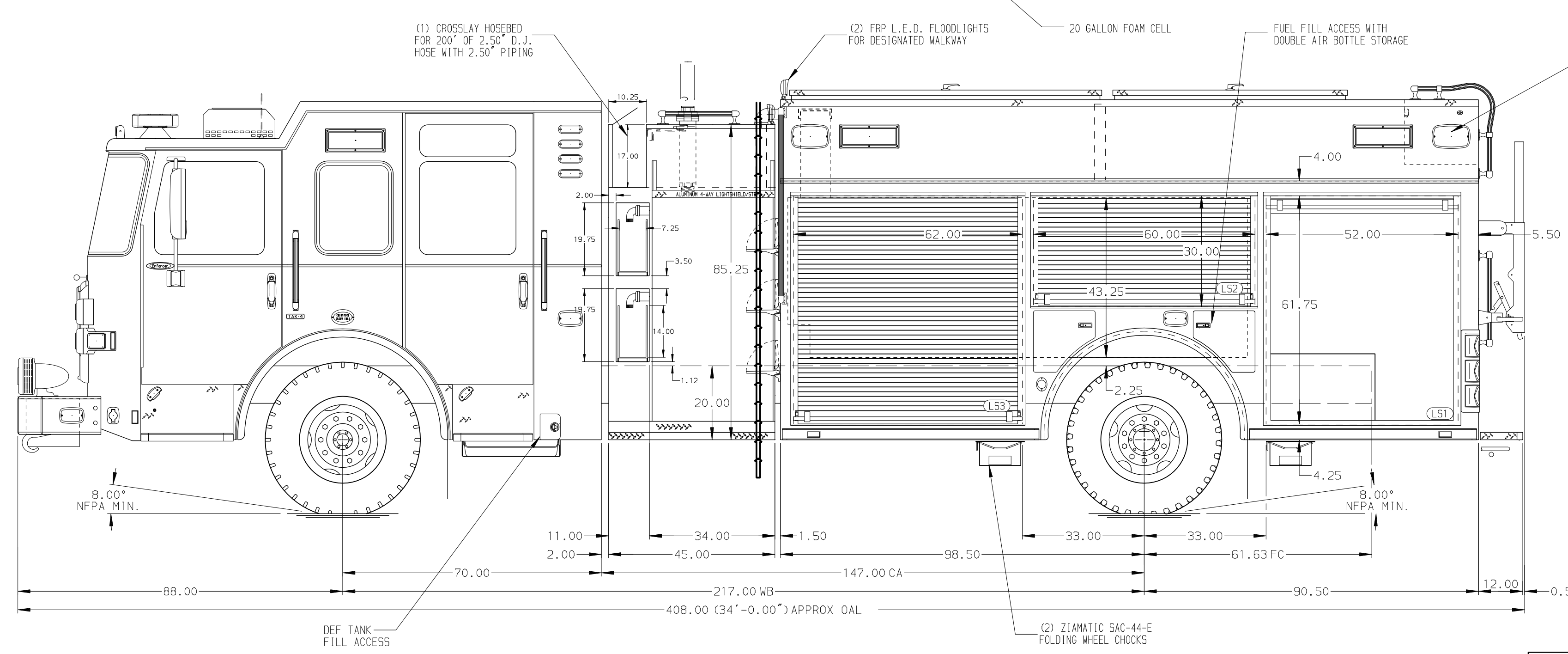

ALUMINUM BODY

SIDE ROLL AND FRONTAL IMPACT PROTECTION

NOTE
DIMENSIONS SHOWN ARE APPROXIMATE AND ARE SUBJECT TO MINOR DEVIATIONS AS MAY OCCUR OR BE NECESSARY IN CONSTRUCTION. MINOR DETAILS NOT SHOWN.

1. ONE 1.50 OUTLET WITH 2.00 PIPING AND SHIVEL LOCATED IN CENTER BUMPER TRAY
2. SHORELINE RECEPTACLE WITH KISSMALL SUPER AUTO-EJECT LOCKED ON DRIVER SIDE OF THE CAB
3. AIR INLET WITH DISCONNECT COUPLING IN THE DRIVER SIDE STEPMPELL
4. BATTERY CHARGER LOCATED BEHIND DRIVER'S SEAT
5. BATTERY CHARGE INDICATOR LOCATED ON THE DRIVER SIDE SEAT RISER

CUSTOMER APPROVAL

APPROVED BY: _____
DATE: _____

REV	DATE	BY	CH	ENFORCER



TITLE	1500 GPM, 770G TANK, 750G WATER, 20G FOAM 189" HDRP, MUX
FOR	PIERCE FIELD UNIT APPLETON, WISCONSIN
DWG NO.	45691AD-SH1

JOB NO.	45691
SCALE	1:24
DATE	
DRAWN BY	DLH
CHECKED BY	WME
SHEET SIZE	D
SHEET NO.	1 OF 2